

EUROPAN 7

SUB-URBAN CHALLENGE,
URBAN INTENSITY AND HOUSING DIVERSITY

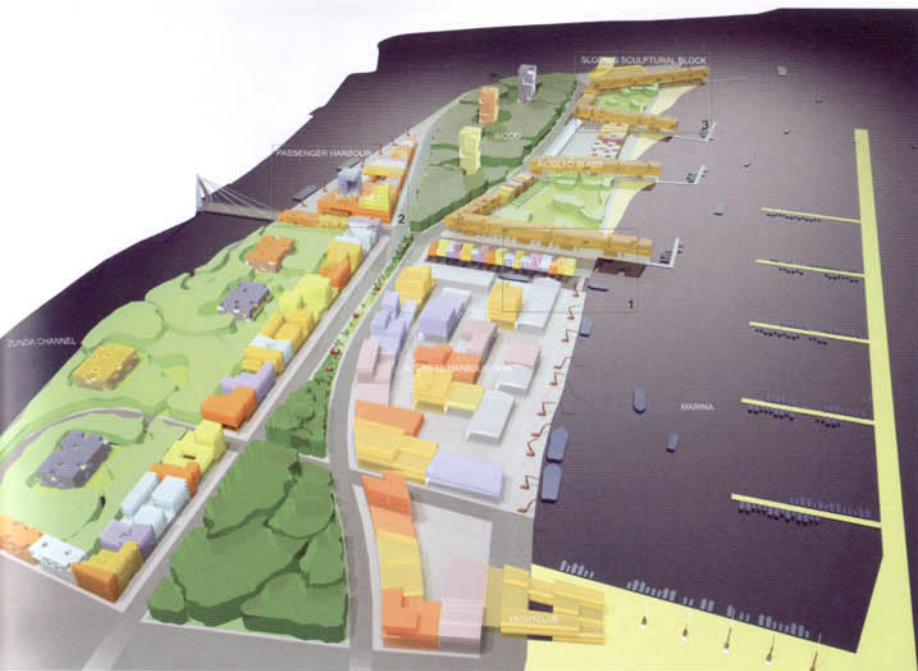

EUROPAN EESTI • EUROPAN LATVIA • EUROPAN SUOMI FINLAND • EUROPAN SVERIGE



HONORARY MENTION

Among the projects which base and unify the new development by a large landscape void. This project proposes a linear park in the axis of the island, defined by the main access. This interesting solution is weakened by a confused design of building and public spaces on the riverbank. The whole looks like a simple collage, although diversity might be necessary. Some objects are totally out of scale.

Vien no projektiem, kurš pamatojas uz plašo, tukšo teritoriju saista to ar jaunu attīstību. Šis projekts piedāvā lineāru parku salas smailē, ko nosaka galvenā piekļūšana. Šo interesanto risinājumu vājāku padara samocītais ēku dizains un sabiedriskās vietas upes krastmalā. Viss kopumā atgādina vienkāršu kolāžu, lai gan dažādība, šķiet, būtu nepieciešama. Daži objekti pilnībā neatbilst mērogam.

NU970

“loop city”

Bonitto, Claudio (I)
Lopapa, Andrea (I)
Ponzo, Giorgio (I)
Garelli, Roberto (I)
Giuliano, Manuel (I)
Menardi, Giorgia Angonova (I)
Nicolino, Walter (I)
Pellegrino, Paolo (I)



Piazza Colle del Prel 29
 12083 Pratonevoso (Cuneo), Italia
 tel. +39 3357220237
 claudiobonitto@iol.it